



Engine output : 15.7 PS
Machine weight : 960 kg

For Earth, For Life
Kubota

KC110 HR-4



COMPACT, POWERFUL AND REDESIGNED FOR BETTER COMFORT, THE NEW KUBOTA KC110HR-4 SAVES YOU TIME AND TROUBLE.



Unloading operation

Unloading operation is fast and easy. The profile of the skip has been designed to ensure a quick discharge of the material. With a dumping angle of 90°, all material exits easily from the skip. In addition, the rotary function allows you to tip side ways (180°) when filling a trench for example.

Clean environmentally friendly engine

Tough and reliable, the water cooled KUBOTA diesel engine delivers high torque, enhanced power (15.7 PS at 2550 rpm) and optimal fuel efficiency to minimise operating costs. It also features cleaner emissions, quieter operation and is easier on the environment.

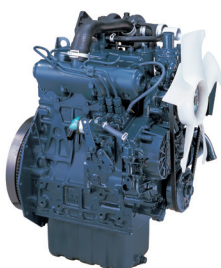

Loading capacity

With a maximum loading capacity of 1000 kg and an heaped volume of 0,52 m³, the KC110HR-4 is a truly productive machine on any work site.



Comfortable and easy operation

All levers and controls are easy to reach and operate. A grab handle bar secures the operator when driving.



KUBOTA CRAWLER DUMPER

KC110HR-4



Compact design

With an overall width of only 990 mm, the KC110HR-4 efficiently transports material through gates and doorways, between houses, buildings and many other narrow spaces.



Foldable foot plate

The KC110HR-4 features a foldable foot plate. When the plate is down, the operator can safely stand on it to operate the machine. When the plate is folded up, the overall length is reduced by 250 mm in order to gain space for transport or storage. The standing operation position makes easy and fast getting on and off the machine.

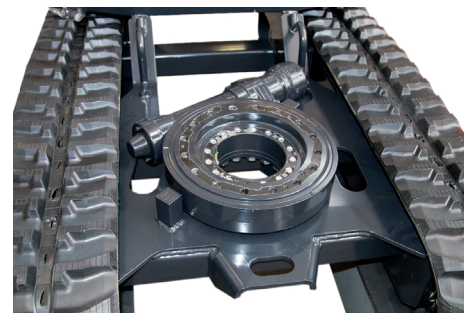

Skip rotation

The skip rotation is powered by a hydraulic swivel motor mounted on a slew ring which insures smooth, precise and fast rotation of the skip through 180°.



Automatic Speedshift

The KC110HR-4 features a two speed transmission (up to 5 km/hr). Combined with auto shift down function, the KC110HR-4 offers maximum traction force in tough conditions or when turning on the spot.



Grease tension system

The rubber crawler is tensioned by a grease cylinder. This feature allows cushioning when foreign materials are going into the crawler. In addition, the short pitch trac offers smooth drive for higher comfort for the operator.



Maintenance

A large opening bonnet gives good access to the main areas for daily maintenance : fuel tank, air filter, engine oil level, reserve tank and battery switch.

Performance

The KC110HR-4 is the ideal workmate of a mini-excavator on a worksite. The crawler type transmission ensures good traction in all conditions while the ground pressure is minimal. The KC110-4 can easily avoid obstacles with a rear angle of gradeability of 28° and a ground clearance of 184.5 mm.



SPECIFICATIONS

Model		KC110HR-4	
Engine	Make	Kubota	
	Model	D722	
	Output kW (PS) / rpm	11.8 (15.7) / 2550	
	Displacement cc	719	
	Cooling system	Water cooled	
Service weight	kg	960	
Max. loading capacity	kg	1000	
Skip tipping system		Hydraulic	
Dumping direction		Rotary / 180°	
Transmission	Type	Hydraulic	
	Hydraulic pump	2 variable pumps	
	Flow (for each pump) ℓ/min	2 x 29.2	
	Hydraulic motors	Trasmital pistons motors	
	Max. pressure bar	175	
	Main valve	5	
Dimensions	Overall length mm	2325 / 2075 (foot step up)	
	Overall height mm	1470	
	Overall width mm	990	
Internal skip dimensions	Length mm	1300	
	Width mm	890	
	Height mm	605	
	Dumping angle deg	90°	
	Heaped volume m ³	0.52	
	Level volume m ³	0.44	
	Ground clearance mm	184.5	
Undercarriage	Tumbler distance mm	1075	
	Rubber shoe width mm	230	
	Track roller	3	
	Travelling speed	1st speed km/h	0 ~ 2.6
2nd speed km/h		0 ~ 5	
(Forward / Reverse) Max. gradeability		20°	
Fuel tank capacity	ℓ	20	
Hydraulic oil tank capacity	ℓ	25	
Ground pressure (loaded)	gr/cm ²	200	

★ The data have been measured on the standard version. Specifications are subject to change without notice.

DIMENSIONS

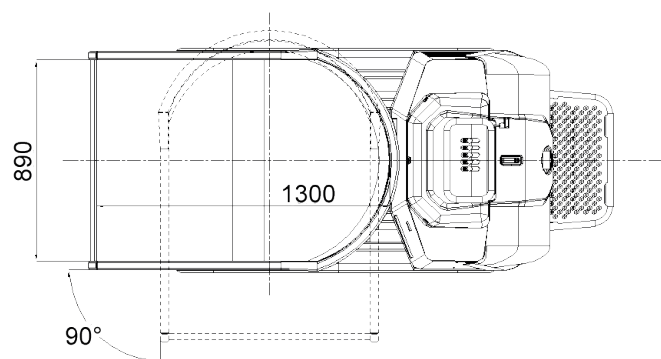
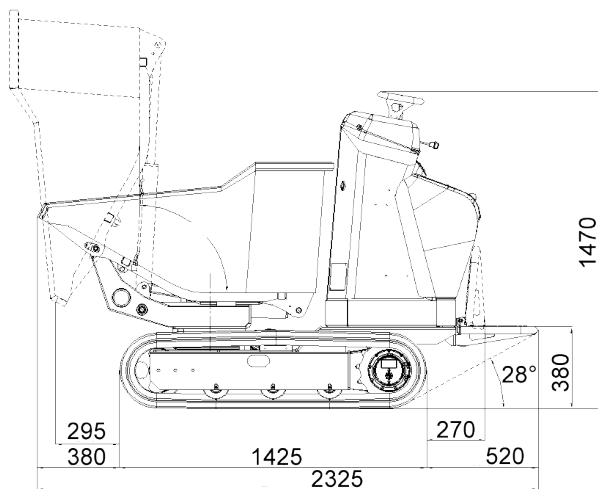
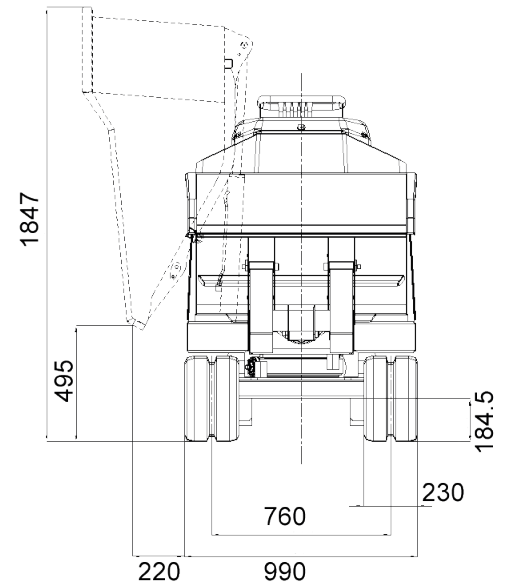

★ All image's shown are for brochure purposes only.
When operating the crawler dumper, wear proper PPE clothing and equipment in accordance to local legal and safety regulations.

KUBOTA EUROPE S.A.S.

19 à 25, Rue Jules Vercey
Zone Industrielle - B.P. 50088
95101 Argenteuil Cedex France
Téléphone : (33) 01 34 26 34 34
Télécopieur : (33) 01 34 26 34 99
<http://www.kubota-global.net>

W21PS02301