



Engine output : 9.4 PS

Machine weight : 580 kg (H) / 660 kg (HV)

For Earth, For Life

Kubota

KC70H/HV-4

KUBOTA CRAWLER DUMPER



COMPACT, POWERFUL AND REDESIGNED FOR BETTER COMFORT, THE NEW KUBOTA KC70H/HV-4 SAVES YOU TIME AND TROUBLE.



Unloading operation

Unloading operation is fast and easy. The profile of the skip has been designed to ensure a quick discharge of the material. With a dumping angle of 88°, all material exits easily from the skip.

Clean environmentally friendly engine

Tough and reliable, the water cooled KUBOTA diesel engine delivers high torque, enhanced power (9.4 PS at 3500 rpm) and optimal fuel efficiency to minimise operating costs. It also features cleaner emissions, quieter operation and is easier on the environment.



Maintenance

A large opening bonnet gives good access to the main areas for daily maintenance : fuel tank, air filter, engine oil level, reserve tank and battery switch.



Compact Design

With an overall width of only 758 mm, the KC70-4 efficiently transports material through gates and doorways, between houses, buildings and many other narrow spaces.



KUBOTA CRAWLER DUMPER

KC70H/HV-4



Grease tension system and short pitch

The rubber crawler is tensioned by a grease cylinder. This feature allows cushioning when foreign materials are going into the crawler. In addition, the short pitch trac offers smooth drive for higher comfort for the operator.

Transmission

The KC70-4 crawler dumpers are equipped with an hydraulic transmission. This advanced transmission offers smooth control, the operator can select the speed best suited for the terrain, and easily shift from High speed (up to 3.8 km/hr) for flat surfaces, to Low speed (up to 2.8 km/hr) for rougher terrain. This system helps make working more efficient and productive, reducing maintenance and also fuel consumption.



Variable undercarriage (KC70HV-4)

The variable undercarriage extends the overall width from 758 mm to 1058 mm. At minimum width, the KC70-4 can easily go through a standard door. At maximum width, the KC70-4 offers great stability in all conditions.



Comfortable & Easy Operation

All levers and controls are easy to reach and operate. A grab handle bar secures the operator when driving.



Foldable foot plate

The KC70-4 features a foldable foot plate. When the plate is down, the operator can safely stand on it to operate the machine. When the plate is folded up, the overall length is reduced by 182 mm in order to gain space for transport or storage. The standing operation position makes easy and fast getting on and off the machine.

Performance

With a maximum loading capacity of 700 kg and an heaped volume of 0.34 m³, the KC70-4 can transport material inside and outside buildings where space to maneuver is limited. The KC70-4 can easily avoid obstacles with a rear angle of 28° and a ground clearance of 202 mm.



SPECIFICATIONS

Model		KC70H-4	KC70HV-4	
Engine	Make	Kubota		
	Model	OC95		
	Output kW (PS) / rpm	7.1 (9.4) / 3500		
	Displacement cc	416		
	Cooling system	Air and oil		
Service weight	kg	580	660	
Max. loading capacity	kg	700		
Skip tipping system		Hydraulic		
Dumping direction		Front		
Transmission	Type	Hydraulic		
	Hydraulic pump	2 gear type pumps		
	Flow (for each pump) ℓ/min	2 x 14.2		
	Hydraulic motors	Orbital motor		
	Max. pressure bar	165		
	Main valve	4 sections		
	Overall lenght	mm	1826 / 2008	
Dimensions	Overall height	1300		
	Overall width	mm	758	758 ~ 1058
	Length	mm	1030	
Internal skip dimensions	Width	mm 675		
	Height	mm 615		
	Dumping angle	deg 88		
	Heaped volume	m ³ 0.34		
	Level volume	m ³ 0.28		
	Undercarriage	Ground clearance	mm	202
Tumbler distance		mm	894	
Rubber shoe width		mm	180	
Track roller		3		
Travelling speed	1st speed	km/h	0 ~ 2.6	
	2nd speed	km/h	0 ~ 3.8	
(Forward / Reverse)	Max. gradeability	Front 15° / Side 20°		
Fuel tank capacity		ℓ	5.5	
Hydraulic oil tank capacity		ℓ	27	
Ground pressure (loaded)		gr/cm ²	200	

*The data have been measured on the standard version. Specifications are subject to change without notice.

DIMENSIONS

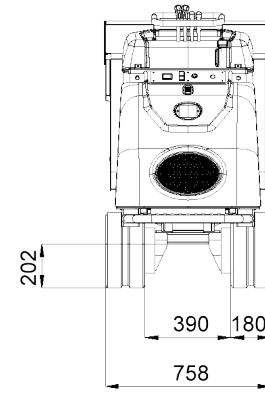

KC70-4 H

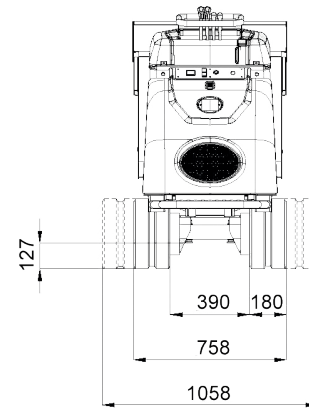

KC70-4 HV

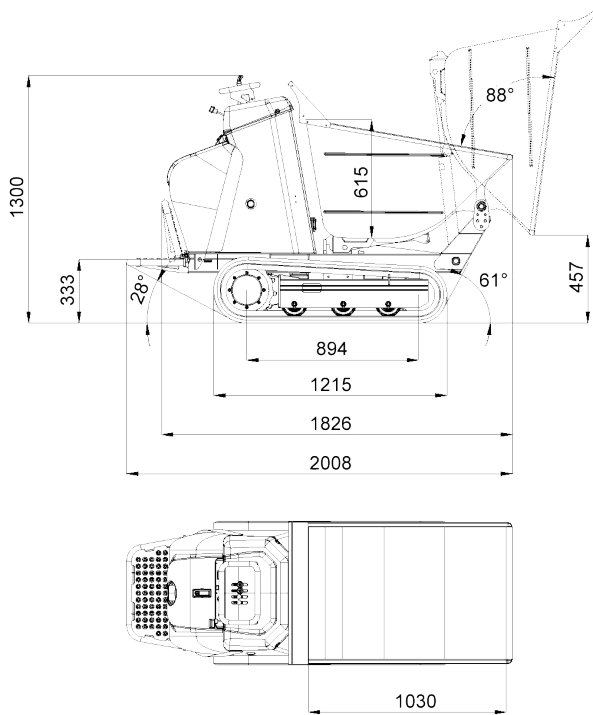

KC70-4 H

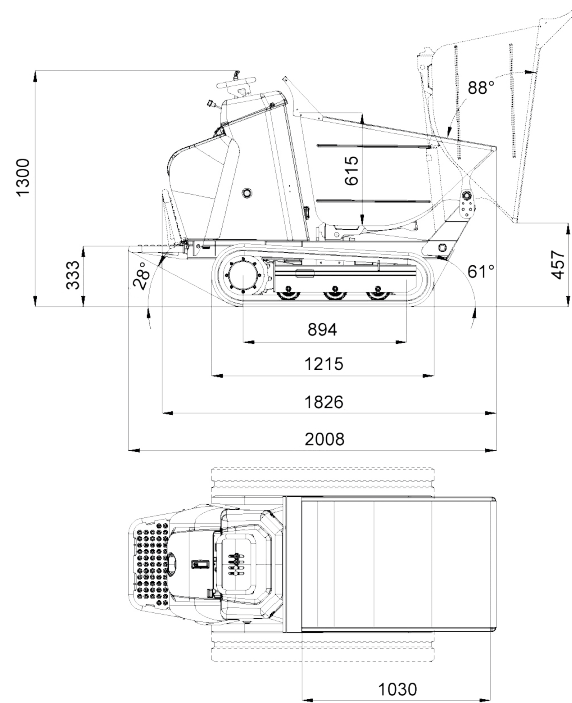

KC70-4 HV

★ All image's shown are for brochure purposes only.
When operating the crawler dumper, wear proper PPE clothing and equipment in accordance to local legal and safety regulations.

KUBOTA EUROPE S.A.S.

19 à 25, Rue Jules Verceyusse
Zone Industrielle - B.P. 50088
95101 Argenteuil Cedex France
Téléphone : (33) 01 34 26 34 34
Télécopieur : (33) 01 34 26 34 99
<http://www.kubota-global.net>

W21PS02300